

YAMAHA XMAX300 TIS FULL SYSTEM R-77J CARBON END

Be sure to read the instruction carefully before starting the work. It is necessary to follow the contents to install Yoshimura product.



CAUTION Before beginning installation, let motorcycle cool down.

CAUTION Be sure not to damage each part during installation.

CAUTION Torque specification must be followed. If neglected, it may cause bolt and nut to fall off and damage to Yoshimura product and motorcycle.

CAUTION Titanium Blue sleeve is colored by anodizing. Handle with care as the color may change. When cleaning silencer, use soft cloth with dish soap but do not use metal polish or chemical cleaner.

1. Product Information :

Description	Yamaha XMAX300 TIS Full System R-77J Carbon End		
Part Number	Stainless Sleeve (SSC) : 1T0A-316-5150	Cyclone Type	Y316S77C1
	Satin Finsh Sleeve (SSFC) : 1T0A-316-5130	Main Material	Stainless steel
	Titanium Sleeve (STC) : 1T0A-316-5180	Weight [STD : 7.2kg]	(SS) & (SSF) : 4.0kg
	Titanium Blue Sleeve (STBC) : 1T0A-316-5180B		(ST) & (STB) : 3.8kg
	Metal Magic Sleeve (SMC) : 1T0A-316-5120		(SM) : 4.0kg

2. Applicable Model :

Model	XMAX 300
-------	----------

3. Contents:

No.	Descriptions	Part No.	Q'ty	No.	Descriptions	Part No.	Q'ty
1	Exhaust Pipe	181-316-5100	1	6	Cap Bolt M10x55	800-210-5055	1
2	Silencer Assy, SS	1T6-316-5150	1	7	Washer M10x22	812-110-2216	1
	Silencer Assy, SSF	1T6-316-5130		8	Spacer 10-24-15	860-010B2415	1
	Silencer Assy, ST	1T6-316-5180		9	Button Bolt M6x20	803-206-4020	2
	Silencer Assy, STB	1T6-316-5180B		10	Washer M6x13	812-206-1310	2
	Silencer Assy, SM	1T6-316-5120		11	Flange Nut M6	823-006-1000	2
3	Silencer Band	162-CAX-1426	1	12	Exhaust Spring MID	118-001-2000	1
4	Silencer Band Rubber	896-016-0835	1	*	Spring Puller Tool	100-000-0000	1
5	Silencer Bracket	161-316-0310	1				

Parts Diagram

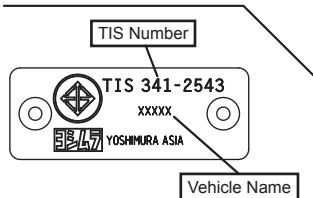
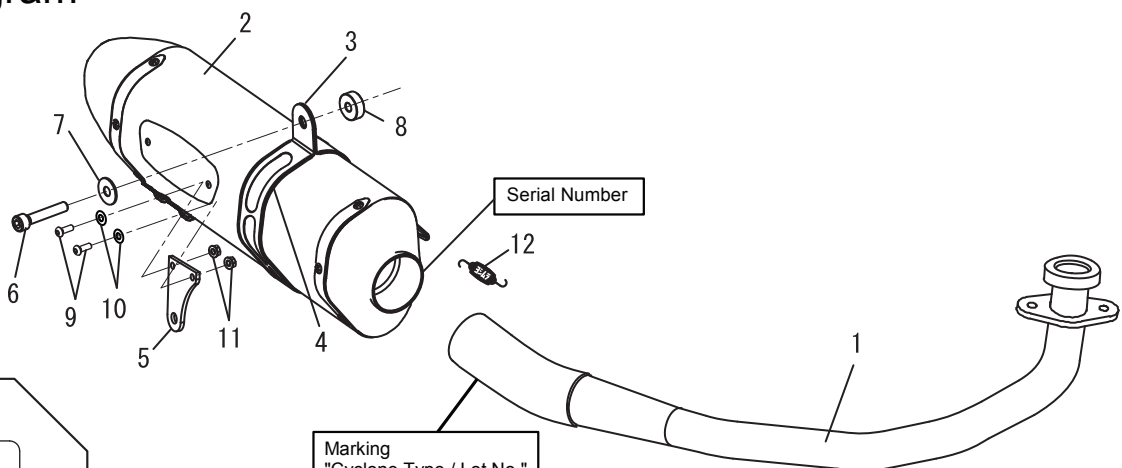

4. INSTALLATION STEPS :

- 1) Check that all the component parts are in hand.
- 2) According to Yamaha Service Manual to remove stock exhaust system (See Fig. 1).

CAUTION When removing exhaust system, be careful not to damage frame, swing arm or other components.

REFERENCE Stock nuts removed at this stage are reused when mounting Yoshimura Exhaust Pipe.



FIG. 1

- 3) Replace stock gasket at exhaust port of engine with new one. Then, mount Exhaust Pipe with stock nuts (See Fig. 2 & 3). Tighten nuts by hand only at this stage.

CAUTION Use Yamaha genuine new exhaust gasket

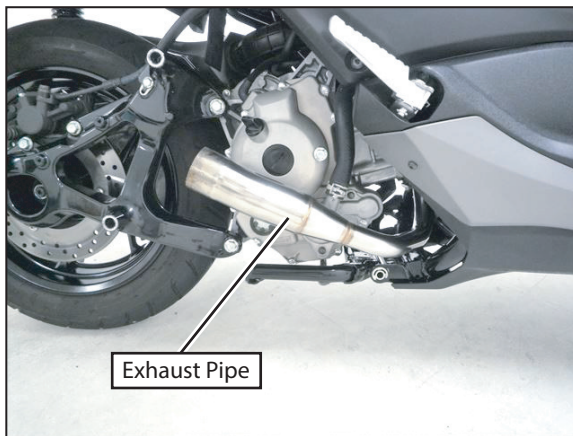

FIG. 2

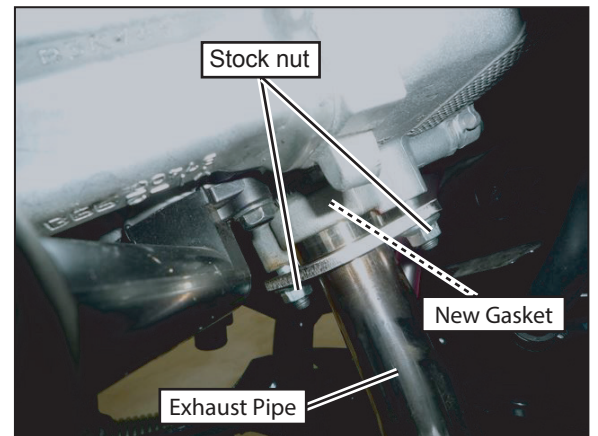

FIG. 3

- 4) Mount Silencer Bracket onto Silencer Assy with 2 of each Button Bolt M6x20, Washer M6x13 and Flange Nut M6 (See Fig. 4, 5). Tighten nuts by hand only at this stage.

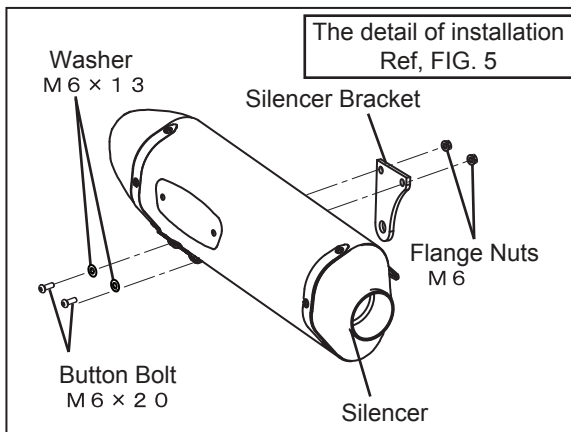

FIG. 4

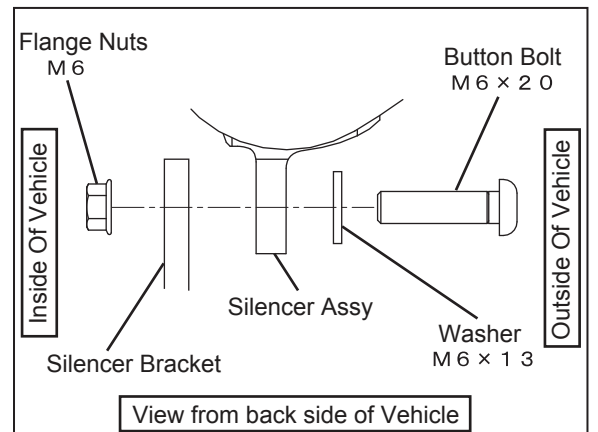

FIG. 5

- 5) Install Silencer Assy to Exhaust Pipe. Then, fix them with the Exhaust Spring and attach Silencer Bracket to Stock silencer mount with Stock Bolt (See Fig. 6, 7) Tighten bolts by hand only at this stage.

CAUTION Make sure that exhaust spring is hooked to spring installation tool firmly. If neglected, it may cause injury.

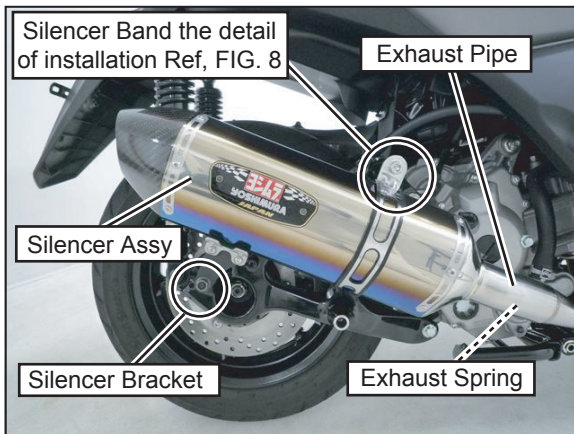

FIG. 6

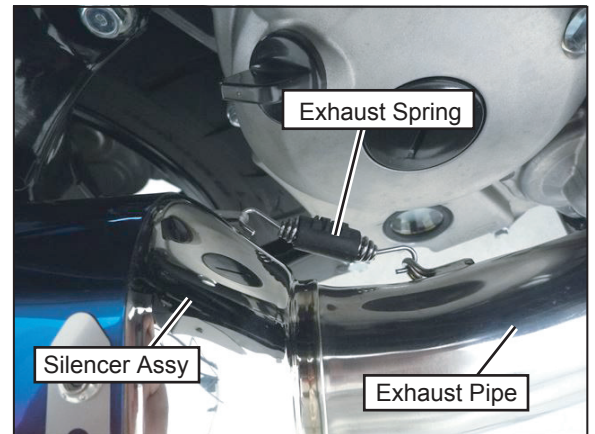
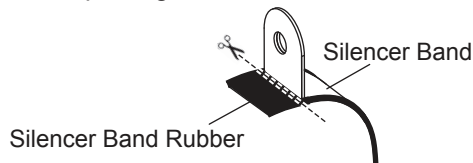

FIG. 7

- 6) Place Silencer Band Rubber into Silencer Band and attach Silencer Band on Silencer Assy. Then, fix Silencer Band to Stock silencer mount with Cap Bolt M10x55, Washer M10x22 and Spacer 10-24-15 (See Fig. 6 & 7) Tighten the nut by hand only at this stage.

REFERENCE

Cut excess of Silencer Band Rubber with scissors etc. when placing it inside Silencer Band.



CAUTION Be sure to place Silencer Band at right angles to Silencer Assy. If neglected, it may cause breakage to Silencer Band.

CAUTION Before hand-tighten Silencer Band, make sure silencer sleeve and Silencer Band fit evenly and there is no opening between them. If neglected, it may cause deformation of silencer sleeve.

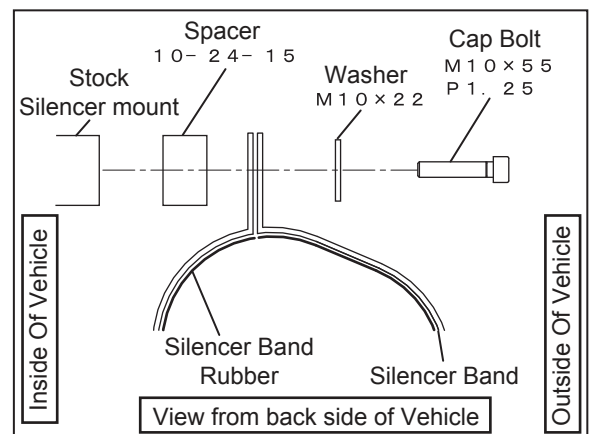

FIG. 8

- 7) Check that there are proper clearances between Yohimura Exhaust System and other components, and adjust the position and angle of Silencer Assy. Then, tighten and torque stock nuts on flange, Stock Bolt at Silencer Bracket, Button Bolt M6x20 at Silencer Bracket and Cap bolt M10x55 at Silencer Band in order (See Fig. 9)

Tightening Torque

- Ⓐ 2-Stock nut at exhaust port : 15 Nm
- Ⓑ Stock Bolt at Silencer Bracket : 23 Nm
- Ⓒ 2-Button Bolt M6x20 at Silencer Bracket : 10 Nm
- Ⓓ Cap bolt M10x55 at Silencer Band : 23 Nm

CAUTION Torque specification must be followed.

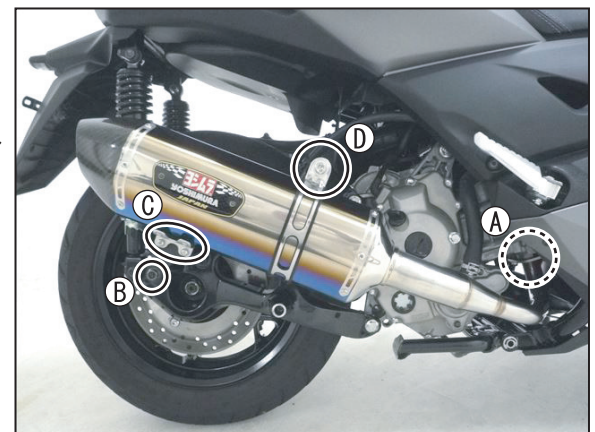

FIG. 9

- 8) It is recommended that whole exhaust to be wiped down with dish soap to remove oil and fingerprints. This will prevent from tarnishing of finish after exhaust system heats up.

CAUTION When cleaning silencer, use soft cloth with dish soap. Do not use metal polish or parts cleaner. If neglected, Titanium Blue color may tarnish.

- 9) Warm-up engine, and inspect exhaust leaking. If "after fire" sounds severely, seal gaps of joint between pipes with heat resistant silicone gasket etc. Then, tighten all bolts and nuts further after engine cools down.

CAUTION Before beginning the work, let motorcycle cool down.

REFERENCE It is normal for new silencer to smoke until inside oil residue burns off.



Yamaha X-Max300 Full System R-77J

Product Information



Carbon Heat Guard Set Type-2
(PARTS NO. 161-000-A620)

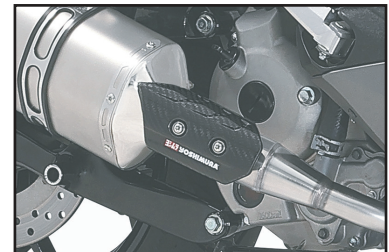

CAUTION

Titanium Blue sleeve is colored by anodizing. Handle with care as the color may change. When cleaning silencer, use soft cloth with dish soap but do not use metal polish or chemical cleaner.

CAUTION

This exhaust is produced for track-day use or for areas where it is not necessary to use a fully legal exhaust. If it is used for racing or on a chassis dynamometer, any damage or carbon discoloration is not included in warranty.

REFERENCE

Yoshimura Asia recommends silencer inner wool replacement every 5,000km (3,000miles) in order to get Yoshimura exhaust performance fully. Climate, riding condition, and frequency of ride are direct contributing factors for inner wool worn out. Keeping high engine revolution also promotes further wool consumption. For silencer repairing, please contact local Yoshimura distributor for further information.

- CAUTIONS AFTER INSTALLATION -

- ⊙ Check each bolt sometimes to see that there is no failure condition such as poor tightening.
- ⊙ Quality control is implemented on all products. If, however, any defect or failure is found, please notify Yoshimura Asia through the selling dealer. Necessary technical service or replacing of the product will be made.
- ⊙ Due to improvement, the specifications and price of the product are subject to change without notice.
- ⊙ For any information regarding this product, please address inquiries to Yoshimura Asia Co., Ltd.

Yoshimura Asia Co., Ltd.

118/3 Moo 18, KLONGNUENG, KLONGLUANG, PATHUMTHANI 12120, THAILAND

Web site: <http://www.yoshimura.asia>